



*Select*

**EMI**<sup>®</sup>

EVEREST METAL INDUSTRIES L.L.C.

Manufacturers of  
Cable Management Systems

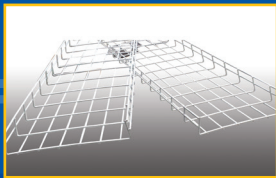
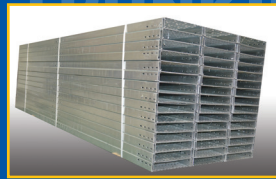

*Building Relationships*



(Listed Products)

Series 6' 15

## Introduction

Our aim at Everest Metal Industries LLC (EMI) is to offer a high quality, competitively priced Cable Management System for the Electrical Market.

Today's Electrical installers requirements are wide and varied and EMI Cable Management Systems are ideally placed to meet these needs. Whatever Cable Support System is required, EMI Cable Management Systems offers a system that will provide the solution to the clients needs.

Light weight Cable Trunking, Single or Multi-Compartment, Perforated Trays and Cable Ladders, Floor Trunking, Wire Mesh are available in standard sizes can be manufactured and also to the client requirements. Metal Framing supports are also available with wide range of bracketory.

EMI factory is located in the Industrial area in Dubai Investment Park-2 and ideally located to service to the whole of the United Arab Emirates having sales offices in Dubai, Abu Dhabi & Other Gulf Countries.



Our staff have been selected from their wealth of experience covering Electrical, Mechanical, and Civil Engineering disciplines.

EMI was formed to provide high quality product to service the Electrical and Mechanical installers in the U.A.E. as well as the rest of the Gulf States. Etisalat, ADNOC, ADWEA, DEWA have already used our product ranges. Contractors from all over the region have used EMI Product from Electrical sub-station to Shopping Malls, the Residential Building to Commercial Building, Pumping Station to Airport & Marine Industries etc.

Only prime quality material bought directly from overseas mills is used to produce our Trunking, Ladder and Perforated Tray Products.

## EMI QUALITY POLICY

The DRIVING FORCE in the successful performance of EMI is the incorporation of quality into all our products, equipment and services.

Our policy is to always attain, and wherever possible, exceed the standards expected by our customers. This can only be achieved by developing, establishing and maintaining a Quality Management System that encompasses all of our personnel and activities.

The Quality Program, as described in this manual, has been approved by all levels of management for issue and implementation within the company. The purpose of this program is to ensure that all products, services and equipment provided will meet or exceed the requirements specified by our customers, by appropriate controlling documents and as set forth by corporate management.

EMI will continually improve the Quality Management System.

Each department is required to implement the Quality Program in its area of responsibility. The Director shall resolve conflicts that cannot be resolved by the Quality Manager and department managers.

Resolution of such conflicts shall be in accordance with the requirements of controlling documents and this Quality Manual. I fully support and approve this program.

**Everest Metal Industries L.L.C.**



## CERTIFICATE

Management system as per  
**EN ISO 9001 : 2008**

In accordance with TÜV NORD CERT procedures, it is hereby certified that

**EVEREST METAL INDUSTRIES LLC**  
Dubai Investment Park - 2  
P. O. Box 14204, Dubai  
United Arab Emirates



applies a management system in line with the above standard for the following scope

**Manufacturers of Cable Management Systems**

Certificate Registration No. 44 100 066324  
Audit Report No. 5800 2762

Valid from 2013-01-27  
Valid until 2016-01-28  
Initial certification 2008

  
Certification Body  
at TÜV NORD CERT GmbH

Abu Dhabi, 2014-11-18

This certification was conducted in accordance with the TÜV NORD CERT auditing and certification procedures and is subject to regular surveillance audits.

TÜV NORD CERT GmbH      Langemarckstraße 20      45141 Essen      [www.tuev-nord-cert.com](http://www.tuev-nord-cert.com)

  
Deutsche  
Akreditierungsstelle  
D-2812007/01-01

## CERTIFICATE OF COMPLIANCE

<b>Certificate Number</b>	20140612-E469098
<b>Report Reference</b>	E469098-20140611
<b>Issue Date</b>	2014-JUNE-12

**Issued to:** EVEREST METAL INDUSTRIES L L C  
Po Box 14204  
Dubai UNITED ARAB EMIRATES

**This is to certify that representative samples of**

CABLE TRAY SYSTEMS AND CABLE LADDER SYSTEMS CERTIFIED TO IEC PUBLICATIONS  
CABLE TRAY SYSTEMS- CT-900/3/20HG, CT-600/3/15SS.

CABLE LADDER SYSTEMS- L3-900/3/20HG, L2-900/3/20MP, L3-600/3/15C, L3-900/3/20SS.

Have been investigated by UL in accordance with the Standard(s) indicated on this Certificate.

**Standard(s) for Safety:** Cable management – Cable tray systems and cable ladder systems, IEC 61537

**Additional Information:** See the UL Online Certifications Directory at [www.ul.com/database](http://www.ul.com/database) for additional information

Only those products bearing the UL Classification Mark should be considered as being covered by UL's Classification and Follow-Up Service.

The UL Classification Mark includes: UL in a circle; with the word "CLASSIFIED" (as shown); a control number (may be alphanumeric) assigned by UL; a statement to indicate the extent of UL's evaluation of the product; and the product category name (product identity) as indicated in the appropriate UL Directory.

Look for the UL Classification Mark on the product.

  
William R. Carney, Director, North American Certification Programs  
UL LLC

Any information and documentation involving UL Mark services are provided on behalf of UL LLC (UL) or any authorized licensee of UL. For questions, please contact a local UL Customer Service Representative at [info@ul.com](mailto:info@ul.com).



Page 1 of 1

## EMI – Under Floor Trunking

Underfloor Trunking System is designed for the distribution of power, voice and data services in floors where the trunking is buried in the screed. The Floor boxes are flushed on to the final finish floor level. It is recommended that underfloor trunking is set on a rough slab and ribbon screed. The minimum overall depth of screed is determined by the depth of trunking plus an allowance of 25mm of screed over the trunking. To reduce the possibility of screed cracking, it is recommended that a reinforcing agent be placed over the trunking for additional strength to the screed.

Standard Thickness	1.5mm / 2.0mm
Standard Length	3 Meter
Materials	Manufactured from Pre-Galvanized Sheets to BSEN 10142, ASTM A653 or JISG 3302 Standard.

### Product Codes

Sizes / mm	Code
150x38	UF/638/3/(T)-*C
200x38	UF/838/3/(T)-*C
250x38	UF/1038/3/(T)-*C
300x38	UF/1238/3/(T)-*C

Coding: UF = Under Floor / 6 = Width mm (Eg. 150/25) / 38= Height 38mm / 3= 3 Meter Length / T = Thickness / \*= No of Compartments

Note: Other dimensions and variation are available upon request.

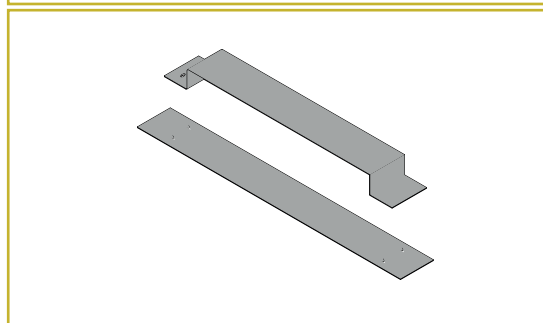
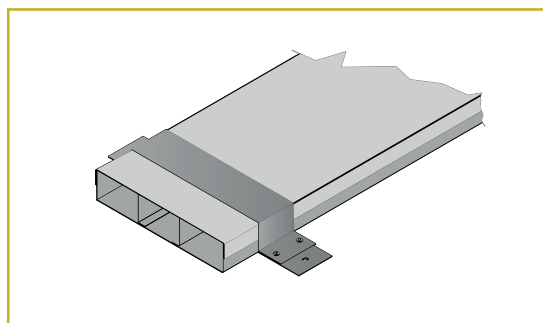

### Riser Bend

UF-RB9/638/(T)-*C	Riser bend for 150x38mm, (*) Compartment Under Floor Trunking
UF-RB9/838/(T)-*C	Riser bend for 200x38mm, (*) Compartment Under Floor Trunking
UF-RB9/1038/(T)-*C	Riser bend for 250x38mm, (*) Compartment Under Floor Trunking
UF-RB9/1238/(T)-*C	Riser bend for 300x38mm, (*) Compartment Under Floor Trunking

\*Number of Compartment / T=Thickness

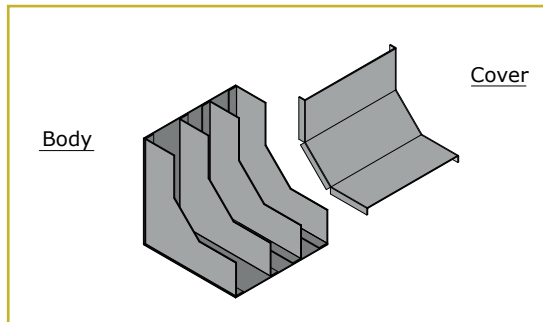

### Tee Junction

UF-T/638/(T)-*C	Tee for 150x38mm, (*) Compartment Under Floor Trunking
UF-T/838/(T)-*C	Tee for 200x38mm, (*) Compartment Under Floor Trunking
UF-T/1038/(T)-*C	Tee for 250x38mm, (*) Compartment Under Floor Trunking
UF-T/1238/(T)-*C	Tee for 300x38mm, (*) Compartment Under Floor Trunking

\*Number of Compartment / T=Thickness

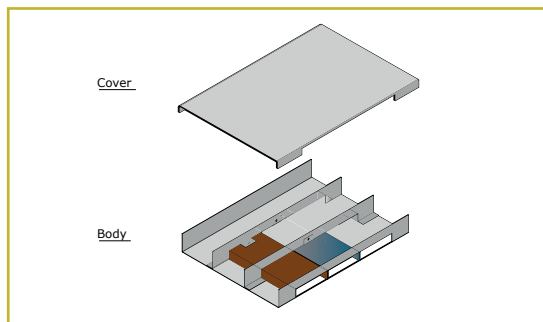



## EMI – Under Floor Trunking

### 90° Bend

UF-HB9/638/(T)-*C	90° Horizontal bend for 150x38mm, (*) Compartment Under Floor Trunking
UF-HB9/838/(T)-*C	90° Horizontal bend for 200x38mm, (*) Compartment Under Floor Trunking
UF-HB9/1038/(T)-*C	90° Horizontal bend for 250x38mm, (*) Compartment Under Floor Trunking
UF-HB9/1238/(T)-*C	90° Horizontal bend for 300x38mm, (*) Compartment Under Floor Trunking

\*Number of Compartment / T=Thickness

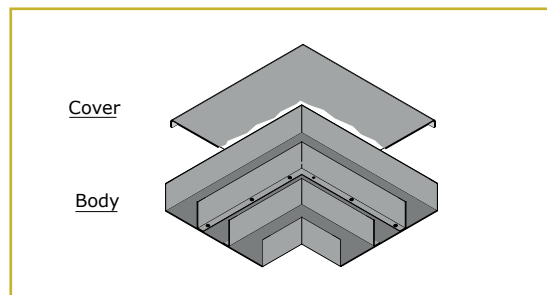

### 45° Bend

UF-HB4/638/(T)-*C	45° Horizontal bend for 150x38mm, (*) Compartment Under Floor Trunking
UF-HB4/838/(T)-*C	45° Horizontal bend for 200x38mm, (*) Compartment Under Floor Trunking
UF-HB4/1038/(T)-*C	45° Horizontal bend for 250x38mm, (*) Compartment Under Floor Trunking
UF-HB4/1238/(T)-*C	45° Horizontal bend for 300x38mm, (*) Compartment Under Floor Trunking

\*Number of Compartment / T=Thickness

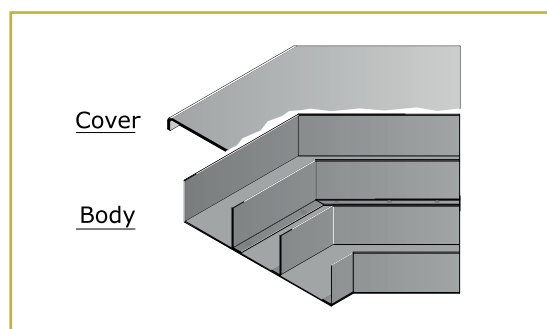

### End Cap

UF-BE/638/(T)	Blank End for 150x38mm Under Floor Trunking
UF-BE/838/(T)	Blank End for 200x38mm Under Floor Trunking
UF-BE/1038/(T)	Blank End for 250x38mm Under Floor Trunking
UF-BE/1238/(T)	Blank End for 300x38mm Under Floor Trunking

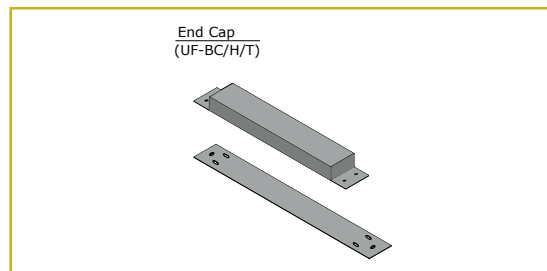

### Junction Box

Part No.	Overall Height	Description
UF-J250x250	75-90mm Adj. Height	Under Floor Junction Box 250x250mm
UF-J300x300	75-90mm Adj. Height	Under Floor Junction Box 300x300mm

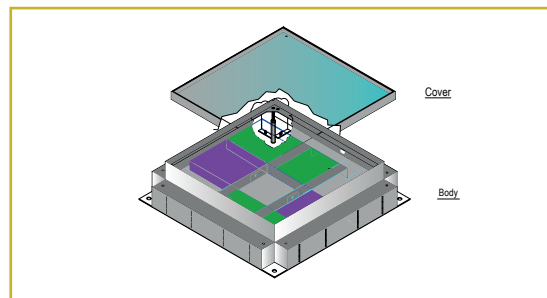

### Service Outlet Box

Three Compartments Access Floor Box designed for Under Floor Installations. The Floor box manufactured from Pre Galvanized Steel which will be suitable for under floor Trunking and 20 & 25mm Knockout punched to accept flexible conduits.

	Overall Height	Description
UF-S250x250	75-90mm Adj. Height	Under Floor Service Outlet Box 250x250mm
UF-S300x300	75-90mm Adj. Height	Under Floor Service Outlet Box 300x300mm

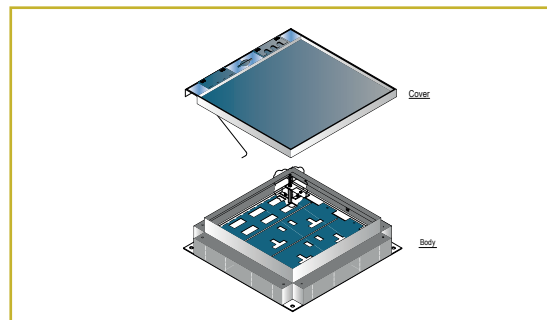

## EMI – Under Floor Trunking

EMI-Under Floor Trunking  
General Arrangement Drawing

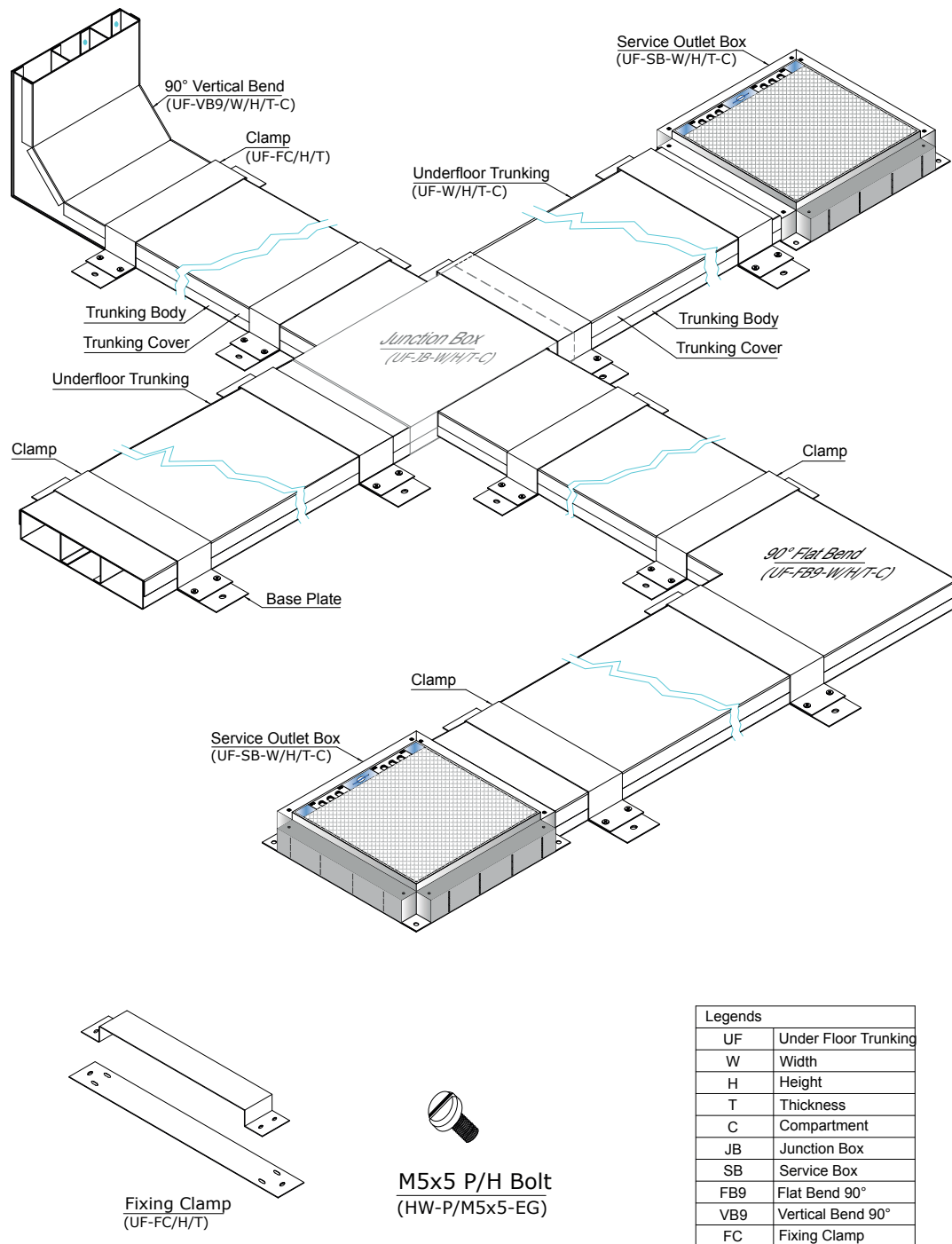

Note : Under Floor Trunking & Accessory available in different size.

## EMI - Flush Floor Trunking

Flush floor Trunking is used in commercial offices and mostly are for dry cleaned and carpet finish floor. It is more flexible then the under floor trunking systems in terms of relocation of service outlet boxes. Also it is easy to extend in any particular direction. This trunking always in the level of finished floor and service outlets directly sits on the trunking.

Standard Thickness	Body - 1.5 mm & Lid - 2.5 mm or 3.0 mm
Standard Length	3 Meter
Materials	Manufactured from Pre-Galvanized Sheets to BSEN 10142, ASTM A653 or JISG 3302 Standard.

### Product Codes

Sizes / mm	Code
200x65	FF/2065/3/(BT)/(LT)-*C
250x65	FF/2565/3/(BT)/(LT)-*C
300x65	FF/3065/3/(BT)/(LT)-*C

Coding: FF = Flush Floor / 20 = Width mm (Eg.200) / 65 = Height/ 3= 3 Meter Length / BT = Body Thickness / LT= Lid Thickness / \* = No of Compartments

Note: Other dimensions and variation are available upon request.

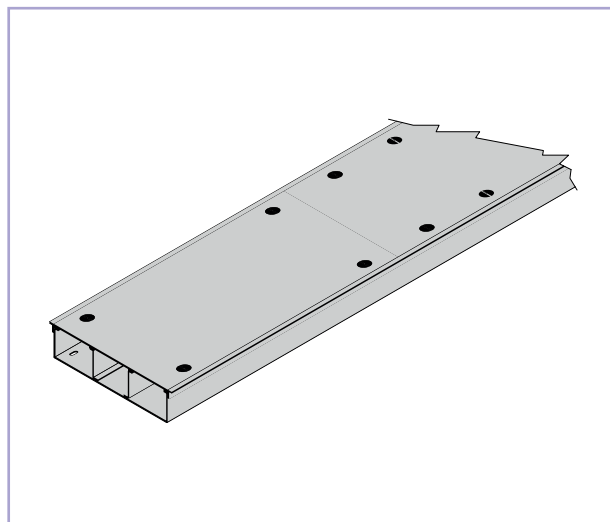

### Riser Bend

FF-RB/2065/(BT)/(LT)-*C	Riser bend for 200x65mm, (*) Compartment Flush Floor Trunking
FF-RB/2565/(BT)/(LT)-*C	Riser bend for 250x65mm, (*) Compartment Flush Floor Trunking
FF-RB/3065/(BT)/(LT)-*C	Riser bend for 300x65mm, (*) Compartment Flush Floor Trunking

\*Number of Compartment / BT= Body Thickness / LT = Lid Thickness

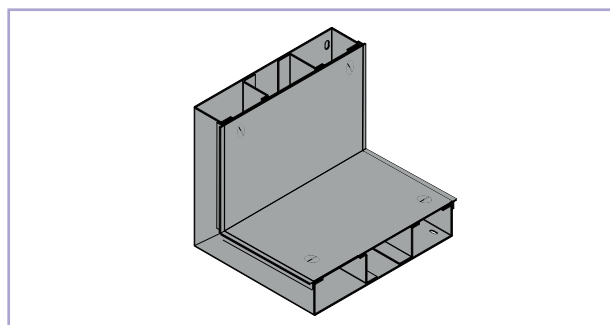

### Tee Junction

FF-T/2065/(BT)/(LT)-*C	Tee Junction for 200x65mm, (*) Compartment Flush Floor Trunking
FF-T/2565/(BT)/(LT)-*C	Tee Junction for 250x65mm, (*) Compartment Flush Floor Trunking
FF-T/3065/(BT)/(LT)-*C	Tee Junction for 300x65mm, (*) Compartment Flush Floor Trunking

\*Number of Compartment / BT= Body Thickness / LT = Lid Thickness

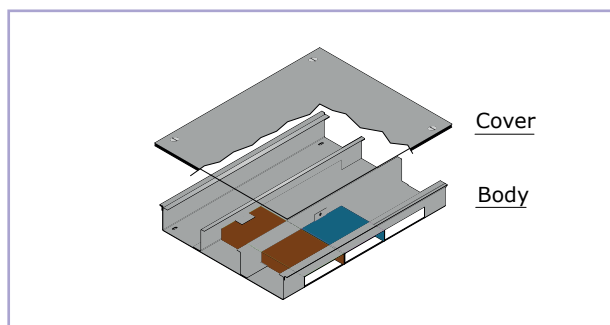

### Junction Box

FF-JB/2065/(BT)/(LT)-*C	Junction Box for 200x65mm, (*) Compartment Flush Floor Trunking
FF-JB/2565/(BT)/(LT)-*C	Junction Box for 250x65mm, (*) Compartment Flush Floor Trunking
FF-JB/3065/(BT)/(LT)-*C	Junction Box for 300x65mm, (*) Compartment Flush Floor Trunking

\*Number of Compartment / BT= Body Thickness / LT = Lid Thickness

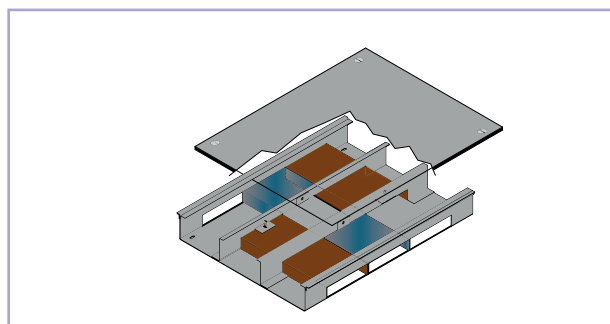

## EMI - Flush Floor Trunking

### 90° Bend

FF-B9/2065/(BT)/(LT)-*C	Horizontal bend 90° for 200x65mm, (*) Compartment Flush Floor Trunking
FF-B9/2565/(BT)/(LT)-*C	Horizontal bend 90° for 250x65mm, (*) Compartment Flush Floor Trunking
FF-B9/3065/(BT)/(LT)-*C	Horizontal bend 90° for 300x65mm, (*) Compartment Flush Floor Trunking

\*Number of Compartment / BT= Body Thickness / LT = Lid Thickness

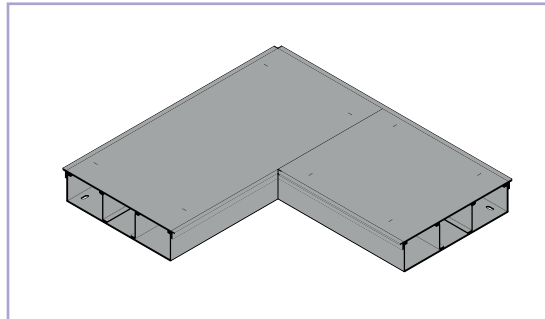

### 45° Bend

FF-B4/2065/(BT)/(LT)-*C	Horizontal bend 45° for 200x65mm, (*) Compartment Flush Floor Trunking
FF-B4/2565/(BT)/(LT)-*C	Horizontal bend 45° for 250x65mm, (*) Compartment Flush Floor Trunking
FF-B4/3065/(BT)/(LT)-*C	Horizontal bend 45° for 300x65mm, (*) Compartment Flush Floor Trunking

\*Number of Compartment / BT= Body Thickness / LT = Lid Thickness

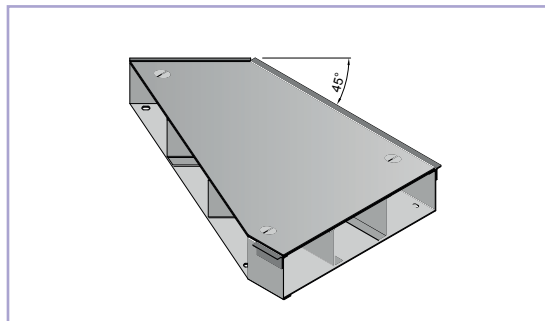

### End Cap

FF-BE/2065/(T)	Blank End for 200x65mm Flush Floor Trunking,
FF-BE/2565/(T)	Blank End for 250x65mm Flush Floor Trunking,
FF-BE/3065/(T)	Blank End for 300x65mm Flush Floor Trunking,

T=Thickness

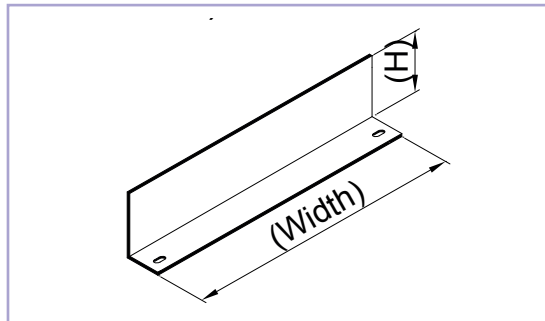

### Service Outlet Box

Three Compartments Access Floor Box designed for Flush Floor Access Installations. The Floor box manufactured from Pre Galvanized Steel.

Part No.	Description
FF-S2065	Service Outlet box for 3 Compt. 200x65mm Flush Floor Trunking
FF-S2565	Service Outlet box for 3 Compt. 250x65mm Flush Floor Trunking
FF-S3065	Service Outlet box for 3 Compt. 300x65mm Flush Floor Trunking

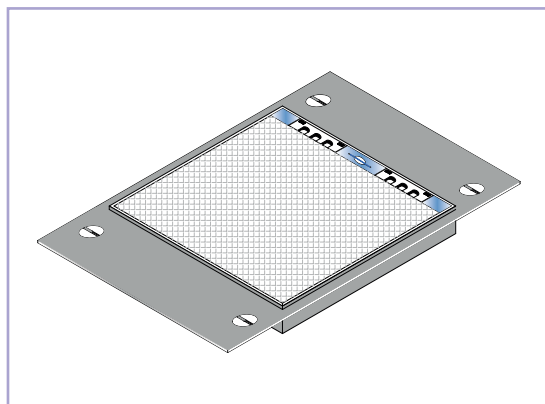



## EMI - Flush Floor Trunking

EMI-Flush Floor Trunking  
General Arrangement Drawing

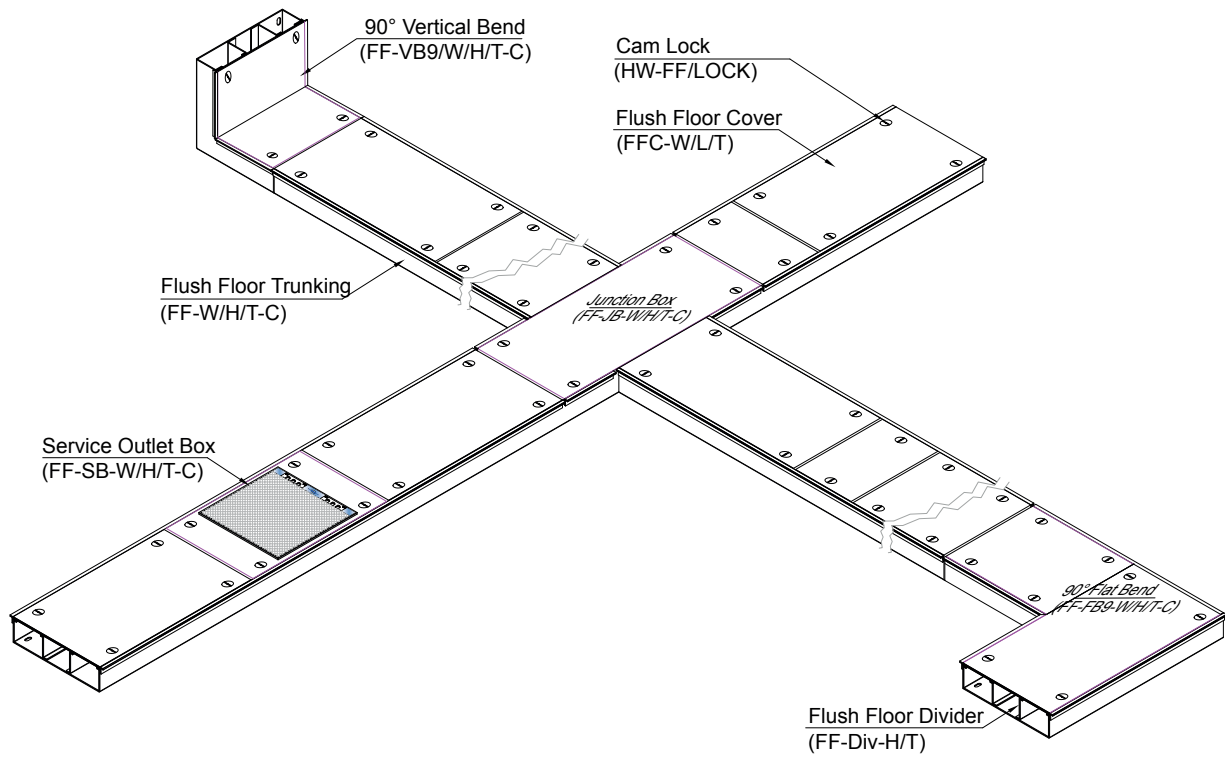

FF Joiners / Coupler  
(FF-CP/T)

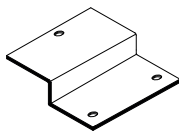

End Cap  
(FF-EC/H/T)

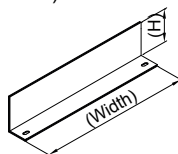

M5x5 P/H Bolt  
(HW-P/M5x5-EG)



Note : Flush Floor Trunking & Accessory available in different sizes.

### Legends

FF	Flush Floor Trunking
W	Width
H	Height
T	Thickness
C	Compartment
JB	Junction Box
SB	Service Box
FB9	Flat Bend 90°
VB9	Vertical Bend 90°
CP	Coupler / Joiners

RAISED FLOORING MODULAR FR CABLES TRAYS

TRAYS LADDERS TRUNKING FLOOR SYSTEM

BATTERIES SKIRTING TRUNKING CABLE CLEATS

RAISED FLO LES TRAYS

TRAYS L R SYSTEM

BATTERIES LE CLEATS

RAISED FLO LES TRAYS

TRAYS L R SYSTEM

BATTERIES SKIRTING TRUNKING CABLE CLEATS

RAISED FLOORING MODULAR FR CABLES TRAYS



Select

**EMI**<sup>®</sup>  
EVEREST METAL INDUSTRIES L.L.C.

Contact Details

Dubai Office - DIP : Tel: +971 4 887 7505 Fax: +971 4 887 7541 email : sales@emiuae.ae  
Abu Dhabi Office : Tel: +971 2 641 3739 Fax: +971 2 641 3794 email : auhbranch@emiuae.ae

[www.emiuae.ae](http://www.emiuae.ae)

In accordance with the manufacturers' policy of continuous improvement, we reserve the right to alter specifications without prior notice. Whilst every precaution has been taken to ensure the accuracy of data, information or recommendations herein no liability in respect of such data, information or recommendations whether given negligently or otherwise can be accepted by the company.